

Hands-On Control

EH-3000 ELECTRONIC HAND THROTTLE AND POSITION CONTROL



AT A GLANCE

- Patented vSENSE™ non-contact sensor provides position sensing and switching accuracy and reliability
- Innovative modular design allows for installation in a wide range of applications and configurations
- Robust design tested for rugged environments and vehicles
- Adjustable actuating force
- Analog and PWM sensors available
- Standard knob, lever or base versions

The EH-3000 Electronic Hand Throttle and Position Control is the latest control to utilize Kongsberg Automotive's leading vSense sensor technology. Designed for the rigors of construction, agricultural and industrial vehicle control, the EH-3000 is intended for use with electronic engines as a hand operated throttle control or as a position control unit.

Designed to provide ease of installation and mounting, flexibility of input mechanisms, and variability of angular movement, this product is adaptable for a wide range of electronic control applications requiring a robust, durable design. The compact, fully sealed unit offers extended service life in the harshest environments. With multiple sensor output options, the vSense non-contact sensor may be calibrated to meet the customer's exact requirements.

This device can be used as a stand alone product or it can be used in conjunction with other Kongsberg Automotive products to create a complete control system for virtually any type of heavy duty vehicle.

EH-3000 ELECTRONIC HAND THROTTLE AND POSITION CONTROL

PRODUCT SPECIFICATIONS

| SENSOR PARAMETER | SPECIFICATIONS |
|-------------------------------------|--|
| Operating Voltage | Analog 5V +/- 0.5V PWM 7.5V to 32V |
| Product Life (Full Travel Cycles) | 500,000 |
| Output Range (programmable) within: | Minimum >7% of supply voltage Maximum <90% of supply voltage |
| Travel Angle Range: | 90° and 54°(standard) |
| Operating Temperatures: | -40°C to +85°C (-40°F to +185°F) |
| Storage Temperature: | -54°C to +85°C (-65.2°F to +185°F) |
| Salt Spray: | 96 Hours |
| Solid Objects and Water Ingress: | Sensor IP67 rated |
| Connector: | Integrated Metri Pack (standard) Alternative connectors available. |
| Specification Compliances: | ASTM B633; ASTM B117-97, SAE J726, SAE J1843, SAE J1455, KA PS-462, PS-00522 |
| Engine Compatibility: | • Caterpillar • Cummins • DAF • Daimler • Detroit Diesel • Deutz • Hino • Iveco • John Deere • Kubota • MAN • MTU • Navistar • Perkins • Scania • Shanghai Diesel • Sisu Diesel • Volvo • Weichai |
| Engine Input Options: | Single Analog, Dual Analog, Single Analog w/IVS, PWM |

STANDARD MOUNTING DIMENSIONS

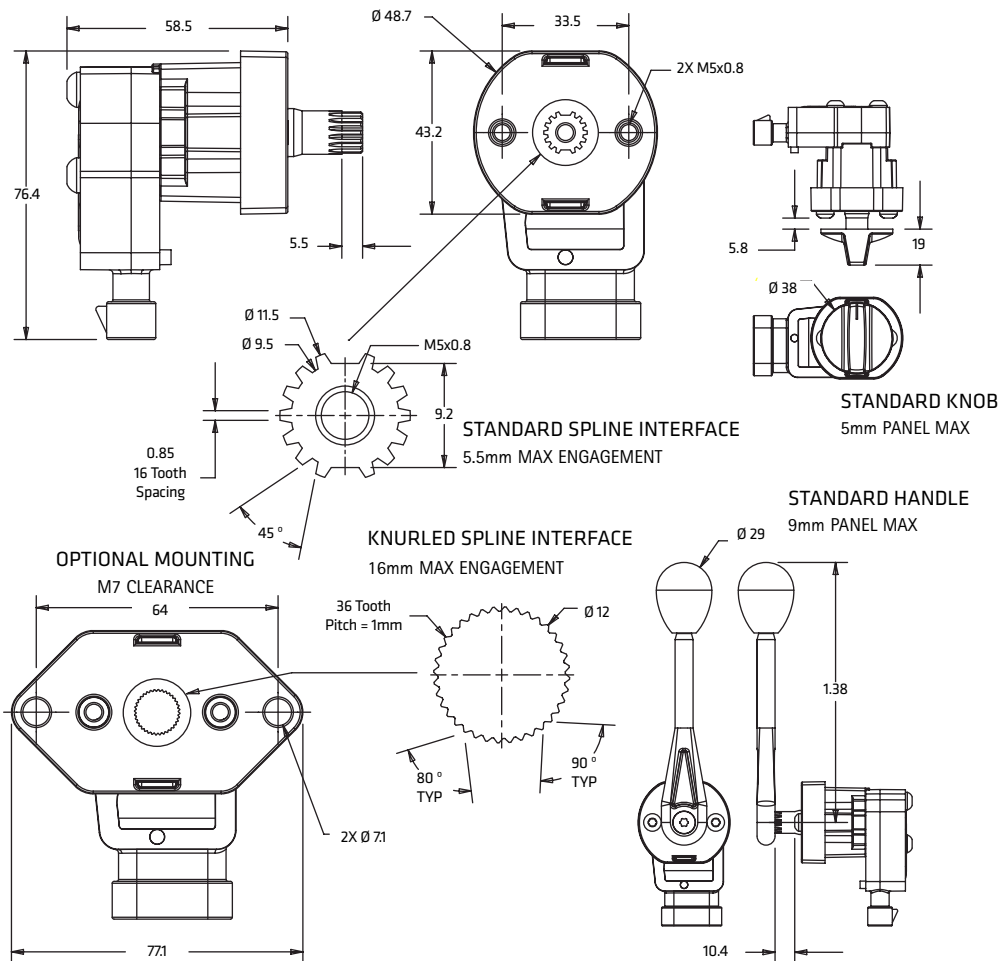

MOUNTING HARDWARE

Standard Mounting: M5 x 0.8 x 30 Pan Head screws recommended.

Optional Mounting: M7 x 1 x 30 Pan Head screws with nuts recommended.

FEATURES:

- Industry leading and patented vSENSE™ Hall effect non-contact sensor provides accuracy and reliability
- Analog and PWM sensors available
- Robust, durable design
- Factory set friction mechanism holds position resistant to vibration
- Adjustable actuating force
- Customizable mounting options available
- Various travel angles available
- Available with or without standard knob, or lever.
- Dynamic IP67 sensor
- Optional outputs available
- Industry leading cycle life

BENEFITS

- Modular design permits customization to fit packaging and user interface needs
- Can be considered for extreme environmental conditions
- Cycle life provides minimal maintenance costs

CONNECTOR OPTIONS

- Integrated sensor output
- 6-pin Integrated Metripack (Std)
- 6-pin Deutsch (Harness)
- 3-pin Weatherpack (Harness)
- 3-pin Round Deutsch (Harness)



KONSGBERG
AUTOMOTIVE